

# SFW series 2/2 Solenoid Valve

Product features/ Code of order

**CHELIC**

## Feature

- Suitable for air, water, and vacuum applications
- 2-port, 2-position type
- Compact design, space-saving
- Resin body (PSS)

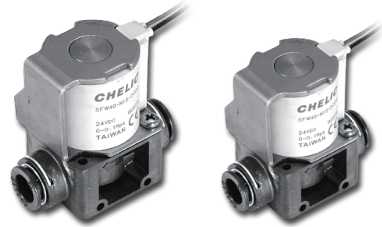

## Specification

Item	Model	SFW 30	SFW 40
Fluid		Applicable to air, water and vacuum	
Pressure range <small>kgf / cm<sup>2</sup> (kPa)</small>	Air, Water (Normal)	0 ~ 9 ( 0 ~ 900 )	
	Vacuum	-1 ~ 0 ( -100 ~ 0 )	
Withstand pressure <small>kgf / cm<sup>2</sup> (kPa)</small>		10 ( 1000 )	
Ambient and fluid temperature <small>°C</small>		5 ~ 60	
Pilot type		Direct operated	
Number of position ports		2/2 Solenoid valve	
Type of actuation		Normally closed	
Port size		Ø4, Ø6	Ø8, Ø10
Effective orifice (Cv factor) <small>mm<sup>2</sup>(CV)</small>		5.4 ( 0.3 )	19.8 ( 1.1 )
The max. operating pressure differential <small>Note1 kgf / cm<sup>2</sup> (kPa)</small>		1 ( 100 )	0.2 ( 20 )
Weight <small>g</small>		137	174

Note: 1. The max. operating pressure differential is while supply port pressure over exhaust pressure value.

## Code of order **SFW 30 - C4 - D2 - W**



1	Mark	Model number
	30	30 Series
	40	40 Series

2				With fitting port		
Mark	Port	Model				
C4	Ø4	SFW 30				
C6	Ø6					
C8	Ø8	SFW 40				
C10	Ø10					

3			Voltage		
Mark	Wattage	Model			
D1	3.3W	SFW 30			
	7.5W	SFW 40			
D2	3.1W	SFW 30			
	8.1W	SFW 40			

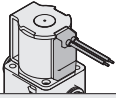
4			Electrical entry		
					
			W: Grommet		
			● W: With wire length 300mm		

## Internal structure

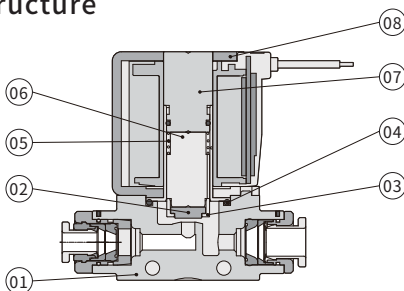

## Components and material list

No.	Item	Material
01	Body	Resin
02	Moving iron core	NBR
03	Rubber valve seat with brass insert	Copper alloy
04	O-ring	NBR
05	Return spring	POM
06	Spring bushing	Stainless steel
07	Coil insert bushing	Stainless steel
08	Electromagnetic coil	—

# SFW series 2/2 Solenoid Valve

## Dimensions/ Single unit

CHELIC

### SFW 30

#### Fluid assembly description:

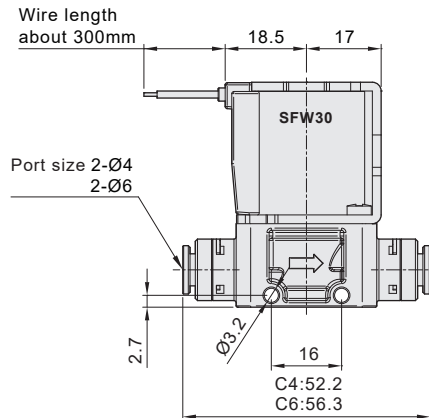
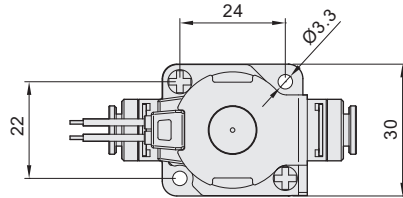
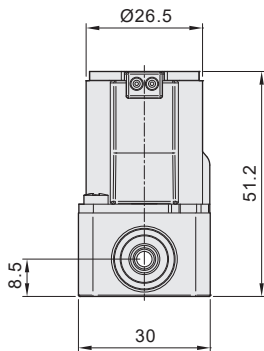
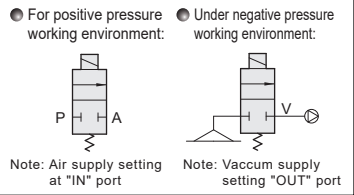

### SFW 40

#### Fluid assembly description:

