

# Vacuum pad

## PLA/PRD





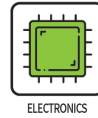
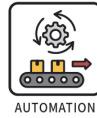

## PT/PFS

# CHELIC®

Applicable

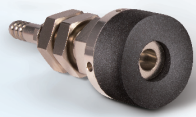
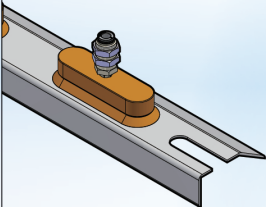
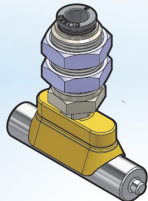
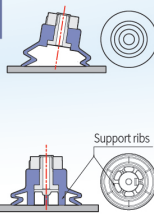
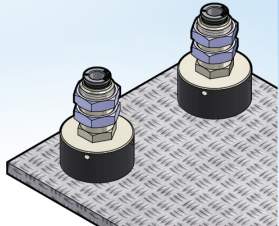

## Varieties of pad sizes, styles and material.

Photos				
Series	PLA Series	PRD Series	PT Series	PFS Series
Styles	Long thin plate pad	Long cylindrical pad	Anti-Skew pad	Sponge pad
Usage	<p><b>Handling long materials:</b> The single piston structure ensures high load resistance that to reduce friction situation.</p> 	<p><b>Designed for cylindrical object adsorption,</b> Batteries, electronic components, and metal tubes.</p> 	<p><b>Anti-Skew Handling:</b> A stable handling during high-speed.</p> <p>It may skewing during handling</p>  <p>PT Series Adsorption</p>	<p><b>Materials with rough surfaces:</b> Available to embossed steel plates and welded electronic components PCBs.</p> 
Bracket	F: Vertical piping K: Vertical piping with joint T: Lateral piping FS: Vertical spring type TS: Lateral spring type			
Pad diameters	Ø23xØ60、Ø30xØ90 Ø40xØ80、Ø16xØ50	Ø9.5xØ25、Ø15xØ30 Ø25xØ70	Ø30、Ø40、Ø50	Ø10、Ø15、Ø20 Ø30、Ø40、Ø50
Material	N: NBR (rubber) SE: Antistatic rubber	PU: Polyurethane E: Low-impedance antistatic rubber	S: Silicone, silicone rubber	EPDM Antistatic, EPDM Non-antistatic
Characteristics	<ol style="list-style-type: none"> <li>Ensures strong sealing and adhesion for secure handling</li> <li>Smooth flow channel for quick absorption</li> </ol>	<ol style="list-style-type: none"> <li>Available in various sizes and materials.</li> <li>Effective for handling oily surface workpieces.</li> </ol>	<ol style="list-style-type: none"> <li>Available in various sizes and materials</li> <li>Utilizes concave and convex adsorption surfaces for improved detachability</li> <li>Reinforced top ribs prevent adsorption and distortion</li> <li>Features a 1.5 corrugated design for a large compression stroke.</li> </ol>	<ol style="list-style-type: none"> <li>Available to workpieces of different sizes and shapes</li> <li>Offers various sizes and bracket options</li> <li>Available to a rough and uneven surfaces without changing suction performance</li> </ol>
Qrcode				

# PRD series Long Cylindrical Pad

## Product features

CHELIC

### Feature

- Available in various sizes and materials.
- Multiple bracket options to meet the needs of different workplaces.
- Effective for handling oily surface workpieces.
- Design for cylindrical workpiece.



### Vacuum pad material

Mark	Vacuum pad material	Hardness (HS)	Ambient and fluid temperature	Color	Electrical resistance(Note)
N	NBR(Rubber)	A60/S	-40~100°C	Green	—
S	Silicon, Silicone rubber	A60/S	-50~180°C	Black	—
SE	Anti-static rubber	A50/S	-50~180°C	Black	10 <sup>4</sup> ~10 <sup>6</sup> Ω·cm
E	Low resistance & anti-static rubber	A70/S	-50~180°C	Black	200Ω·cm

Note: The above value covers only general characteristics of subject rubber materials. Pad materials used by CHELIC pass internal standard.

### Vacuum control system

Theoretical suction is calculated from pad size and vacuum value, which is only a number for reference. Theoretical suction is a number under static status. Please reserve enough margin while adding workpieces and movement.

Before confirm the Qty and location of suction pad, please reserve enough margin.

#### ● Suction type



#### ● Calculation formula

$$W = \frac{P \times A}{-10}$$

W: Force N  
 P: Vacuum pressure kPa  
 A: Pad area dimensions cm<sup>2</sup>

### Theoretical suction

- Pad diameter : Ø5~Ø60

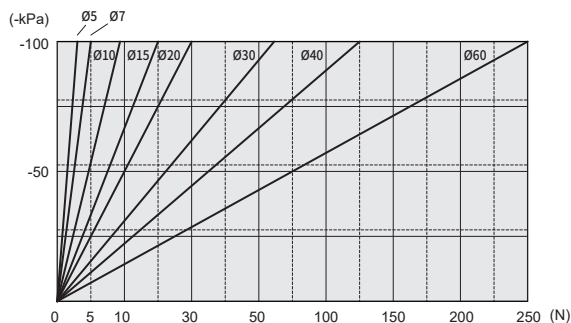

# PRD series Long Cylindrical Pad

Code of order, Vacuum pad size

CHELIC

Code of order **PRD F - 9.5 x**  **- N -**



1	Bracket	Vertical entry	Vertical entry with fitting	Side entry	Vertical entry with spring	Side entry with spring
	Mark	F	K	T	FS	TS
	Image					

2	Mark	Pad size(L x W, mm)
	9.5	9.5x25
	15	15x30
	25	25x70

3	Mark	Stroke (mm)
	6	6
	15	15

● Only available to FS, TS series

4	Mark	Vacuum pad material	Hardness (HS)	Ambient and fluid temperature	Color	Electrical resistance(Notes)
	N	NBR(Rubber)	A60/S	-40~100°C	Green	—
	S	Silicon, Silicone rubber	A60/S	-50~180°C	Black	—
	SE	Anti-static rubber	A50/S	-50~180°C	Black	10 <sup>4</sup> ~10 <sup>6</sup> Ω·cm
	E	Low resistance & anti-static rubber	A70/S	-50~180°C	Black	200Ω·cm

● The above value covers only general characteristics of subject rubber materials. Pad materials used by CHELIC pass internal standard.

5	Mark	Ball joint type	
	None	Without ball joint type	
	R	With ball joint type	

## Vacuum pad size

### ● PRD 9.5x25

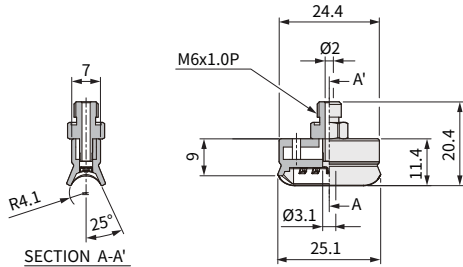

### ● PRD 15x30

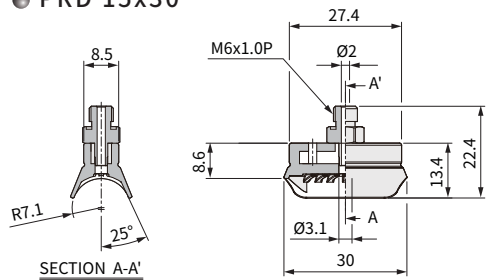

### ● PRD 25x70

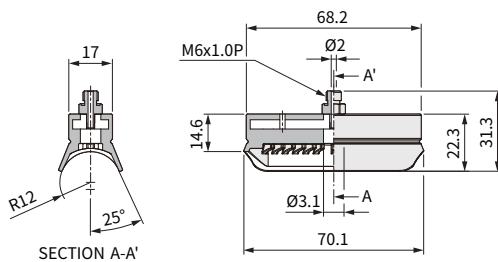

# PRD series Long Cylindrical Pad

Dimensions/ PRDF, PRDK, PRDFS, PRDT series

**CHELIC**

## PRDF series / Vertical entry

► 9.5x25, 15x30, 25x70

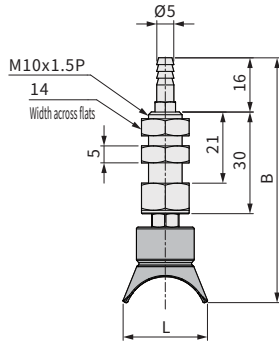

## PRDK series/ Vertical entry with fitting

► 9.5x25, 15x30, 25x70

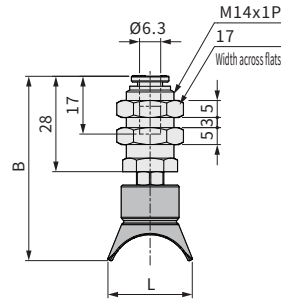

Unit: mm

Model	Short size L	Long size	Whole length B	Size of PU tube
PRDF-9.5x25	9.4	25.1	61.4	PU tube 6x4
PRDF-15x30	14.9	30	63.4	
PRDF-25x70	24.9	70.1	72.4	

Unit: mm

Model	Short size L	Long size	Whole length B	Size of PU tube
PRDK-9.5x25	9.4	25.1	43.4	PU tube 6x4
PRDK-15x30	14.9	30	45.4	
PRDK-25x70	24.9	70.1	54.4	

## PRDT series / Side entry

► 9.5x25, 15x30, 25x70

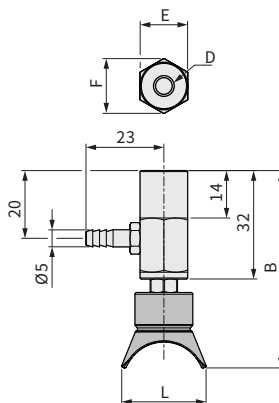

Unit: mm

Model	Short size L	Long size	Whole length B	D	E	F	Size of PU tube
PRDT-9.5x25	9.4	25.1	47.4	M6x1 dp 8	14	16.5	PU tube 6x4
PRDT-15x30	14.9	30	49.4				
PRDT-25x70	24.9	70.1	58.4				

## PRDFS series/ Vertical entry with spring

► 9.5x25, 15x30, 25x70

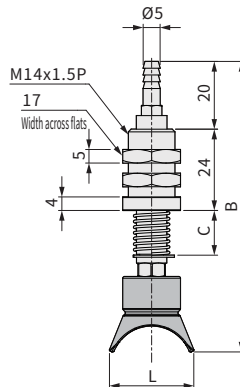

Unit: mm

Model	Short size L	Long size	Stroke 6		Stroke 15		Size of PU tube	Spring compression length
			B	C	B	C		
PRDFS-9.5x25	9.4	25.1	75.4	13	92.4	30	PU tube 6x4	6, 15
PRDFS-15x30	14.9	30	77.4	13	94.4	30		
PRDFS-25x70	24.9	70.1	86.4	13	103.4	30		

# PRD series Long Cylindrical Pad

Dimensions/ PRDTS, PRDF-R, PRDK-R, PRDT-R series

**CHELIC**

## PRDTS series / Side entry with spring

► 9.5x25, 15x30, 25x70

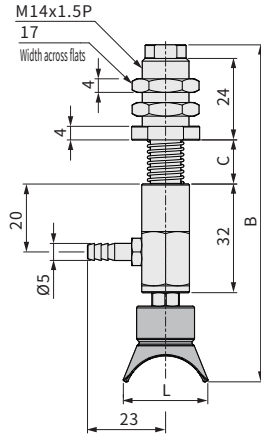

Unit: mm

Model	Short size L	Long size	Stroke 6 B	Stroke 6 C	Stroke 15 B	Stroke 15 C	Size of PU tube	Spring compression length
PRDTS-9.5x25	9.4	25.1	95.4	13	112.4	30	PU tube 6x4	6, 15
PRDTS-15x30	14.9	30	97.4	13	114.4	30		
PRDTS-25x70	24.9	70.1	106.4	13	123.4	30		

## PRDF-R series/ Vertical entry-Ball joint type

► 9.5x25, 15x30, 25x70

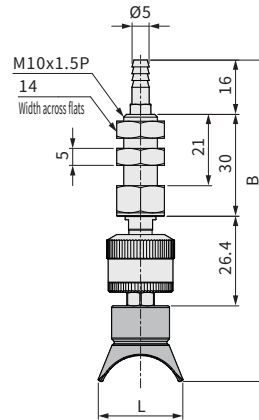

Unit: mm

Model	Short size L	Long size	Whole length B	Size of PU tube
PRDF-9.5x25-R	9.4	25.1	83.8	PU tube 6x4
PRDF-15x30-R	14.9	30	85.8	
PRDF-25x70-R	24.9	70.1	94.8	

## PRDK-R series

Vertical entry with fitting-Ball joint type

► 9.5x25, 15x30, 25x70

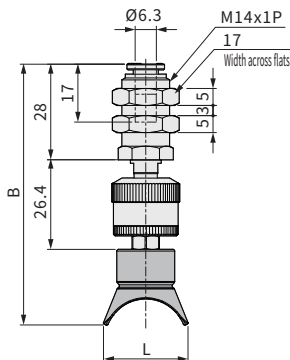

Unit: mm

Model	Short size L	Long size	Whole length B	Size of PU tube
PRDK-9.5x25-R	9.4	25.1	65.8	PU tube 6x4
PRDK-15x30-R	14.9	30	67.8	
PRDK-25x70-R	24.9	70.1	76.8	

## PRDT-R series/ Side entry - Ball joint type

► 9.5x25, 15x30, 25x70

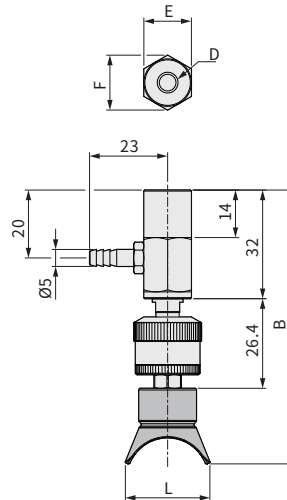

Unit: mm

Model	Short size L	Long size	Whole length B	D	E	F	Size of PU tube
PRDT-9.5x25-R	9.4	25.1	69.8	M6x1 dp 8	14	16.5	PU tube 6x4
PRDT-15x30-R	14.9	30	71.8				
PRDT-25x70-R	24.9	70.1	80.8				

# PRD series Long Cylindrical Pad

Dimensions/ PRDFS-R, PRDTS-R series

**CHELIC**

## PRDFS-R series

Vertical entry with spring - Ball joint type

► 9.5x25, 15x30, 25x70

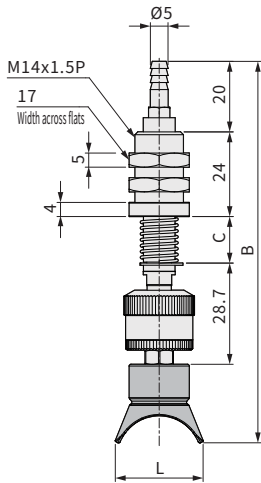

## PRDTS-R series

Side entry with spring - Ball joint type

► 9.5x25, 15x30, 25x70

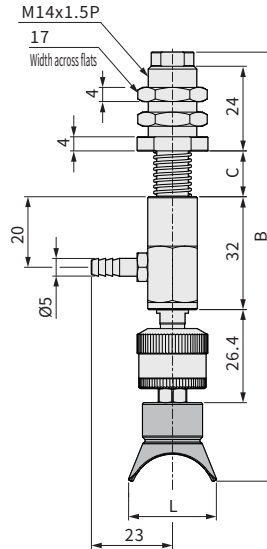

Unit: mm

Model	Short size L	Long size	Stroke 6		Stroke 15		Size of PU tube	Spring compression length
			B	C	B	C		
PRDFS-9.5x25-R	9.4	25.1	97.8	13	114.8	30	PU tube 6x4	6, 15
PRDFS-15x30-R	14.9	30	99.8	13	116.8	30		
PRDFS-25x70-R	24.9	70.1	108.8	13	125.8	30		

Unit: mm

Model	Short size L	Long size	Stroke 6		Stroke 15		Size of PU tube	Spring compression length
			B	C	B	C		
PRDTS-9.5x25-R	9.4	25.1	117.8	13	134.8	30	PU tube 6x4	6, 15
PRDTS-15x30-R	14.9	30	119.8	13	136.8	30		
PRDTS-25x70-R	24.9	70.1	128.8	13	145.8	30		