

JQ1A series Compact Cylinder

Product features

CHELIC

Feature

- To execute JIS standard.
- Cylinder body is with better wear-resistance and durability by treated rolling process and hard anodizing process.
- Contour dual-way seal structure is designed in piston. The features are compact in size and function of oil storage.
- Easy for sensor installation with notches.
- Various accessories are available.

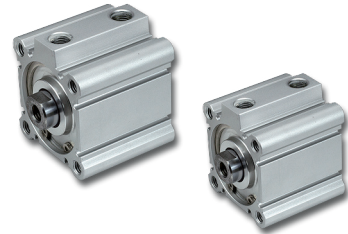

JQ1A

Specification

Item	Bore size (mm)	Ø12	Ø16	Ø20	Ø25	Ø32	Ø40	Ø50	Ø63	Ø80	Ø100
Action		Double acting, Single acting									
Fluid		Air (Filtered through a 40µm filter)									
Pressure range MPa(psi)	Double acting	0.15 ~ 1.0 (22 ~ 145)									
	Single acting	0.2 ~ 1.0 (28 ~ 145)									
Withstand pressure MPa(psi)		1.5 (215)									
Ambient and fluid temperature °C		-20 ~ 70									
Piston speed mm / s	Double acting	30 ~ 500									
	Single acting	50 ~ 500									
Stroke tolerance		Stroke ≤ 100 ^{+0.05} Stroke > 100 ^{+0.5}									
Shock absorber		Cushion									
Port size		M5x0.8			PT1/8			PT 1/4		PT 3/8	

Note: NPT and G thread are available.

Symbol

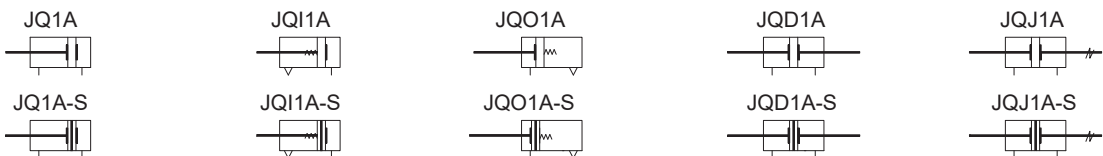

Stroke

Bore size (mm)	Action	Standard stroke (mm)	Max. stroke
12	Double acting	5, 10, 15, 20, 25, 30, 35, 40, 45, 50	50
	Single acting	5, 10, 15, 20	20
Ø16	Double acting	5, 10, 15, 20, 25, 30, 35, 40, 45, 50, 55, 60	60
	Single acting	5, 10, 15, 20	20
Ø20, Ø25	Double acting	5, 10, 15, 20, 25, 30, 35, 40, 45, 50, 55, 60, 70, 75, 80, 90, 100	100
	Single acting	5, 10, 15, 20, 25, 30	30
Ø32, Ø40 Ø50, Ø63	Double acting	5, 10, 15, 20, 25, 30, 35, 40, 45, 50, 55, 60, 70, 75, 80, 90, 100	100
	Single acting	5, 10, 15, 20, 30	30
Ø80, Ø100	Double acting	5, 10, 15, 20, 25, 30, 35, 40, 45, 50, 55, 60, 70, 75, 80, 90, 100	100

Note: 1. Within allowable strokes, please execute non-standard process when stroke > Max. stroke. Please contact us when execute other special strokes.
 2. The non-standard stroke of max. stroke was modified from the last level standard cylinder, so the outline is identical to the last level standard.
 For instance, the non-standard stroke 23 was modified by stroke 25 standard cylinder, so the outline is identical.

JQ1A series Compact Cylinder

Code of order, Product features

CHELIC

Code of order **JQ1A 20 x 30 - B - - - - S 9T 2**



1

Mark	Model
JQ1A	Double acting
JQO1A	Single acting & Normal out
JQI1A	Single acting & Normal in
JQD1A	Double acting & Double-rod
JQJ1A	Adjustable & Double-rod

2

Mark	Bore size (mm)
12	Ø12
16	Ø16
20	Ø20
25	Ø25
32	Ø32
40	Ø40
50	Ø50
63	Ø63
80	Ø80
100	Ø100

3

Bore size(mm)	Stroke (mm)
Ø12	5 ~ 50
Ø16	5 ~ 60
Ø20, Ø25, Ø32, Ø40 Ø50, Ø63, Ø80, Ø100	5 ~ 100

● Refer to stroke list

4

Mark	Thread of shaft
None	Female thread
B	Male thread

5

Mark	Thread type
None	PT thread
N	NPT thread
G	G thread

6

Mark	Adjustable stroke (mm)
10	10
20	20
30	30
40	40
50	50

● Only JQJ1A series has this option

7

Mark	Mounting type
None	Without mounting accessory
FA	Front flange
FB	Rear flange
CB	Double clevis
LB	Foot mounting

● Dual-axis double-acting type without CB mounting type.

8

Mark	Magnet
None	Without magnet
S	With magnet

9

Mark	Sensor switch
None	Without sensor switch
9T	CS-9T

● Image

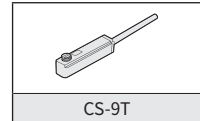

10

Mark	Sensor quantity
None	Without sensor switch
1	With 1 sensor switche
2	With 2 sensor switches

Internal structure

Standard type

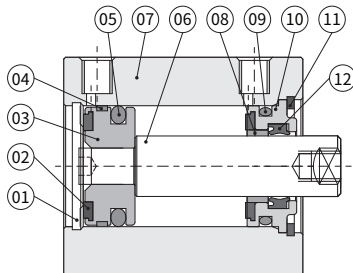

With magnet

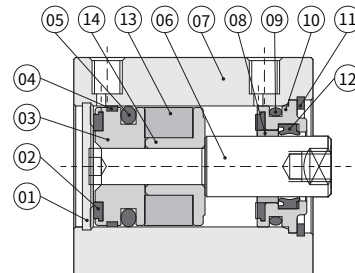

Components and material list

No.	Item	Material	No.	Item	Material
01	Rear cover	None (Ø12, Ø16) \ Aluminum alloy (Other)	08	Bush	None (Ø12~Ø32) \ Wear-resistant material (Other)
02	Cushion gasket	TPU(Ø12~Ø25) \ NBR (Other)	09	O-ring	NBR
03	Piston	Brass(Ø12, Ø16) \ Aluminum alloy (Other)	10	Front cover	Aluminum alloy
04	Wear ring	None (Ø12~ Ø32) \ Wear-resistant material (Other)	11	C Clip	Spring steel
05	Piston packing	NBR	12	Shaft packing	NBR
06	Piston rod	carbon steel (S45C)	13	Magnet	NdFeB magnet(Ø12~Ø25) \ Plastic (Other)
07	Body	Aluminum alloy	14	Magnet base	Brass(Ø12, Ø16) \ Aluminum alloy(Other)

JQ1A series Compact Cylinder

Dimensions / JQ1A

CHELIC

JQ1A

JQ1A Ø12~Ø16

With magnet

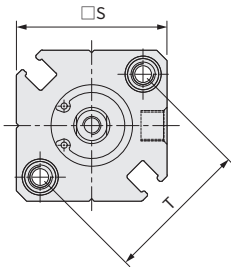

Standard type

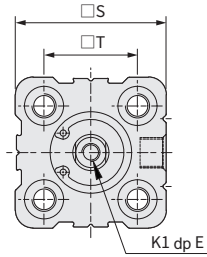

Mounting hole

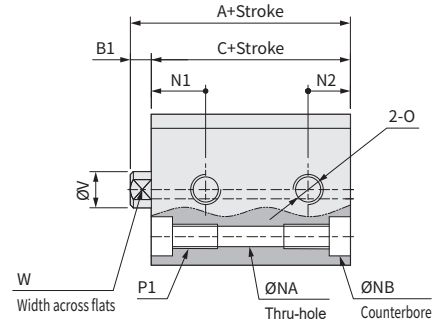

JQ1A Ø20~Ø25

With magnet

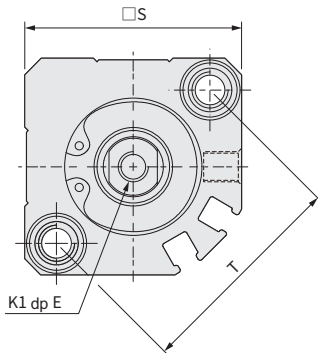

Standard type

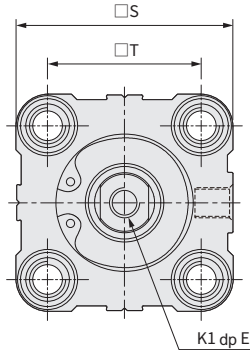

Mounting hole

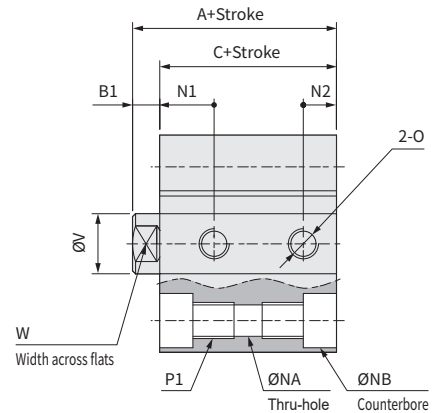

Unit: mm

Mark	Standard type				With magnet		B1	E	K1	N1		N2	
	Stroke		A		C					Standard type	With magnet	Standard type	With magnet
	Bore size	St ≤ 50	St ≥ 60	St ≤ 50	St ≥ 60	A							
12	20.5	—	17	—	31.5	28	3.5	6	M3 x 0.5	7.5	9	5	7
16	22	22	18.5	18.5	34	30.5	3.5	8	M4 x 0.7	8	9.5	5.5	
20	24	34	19.5	29.5	36	31.5	4.5	7	M5 x 0.8	9	9.5	5.5	
25	27.5	37.5	22.5	32.5	37.5	32.5	5.0	12	M6 x 1.0	11		5.5	

Mark	Model	P1	S	T	S	T	D	NA	NB	O	V	W
			Standard type		With magnet							
12		Thread: M4 x 0.7 Screw length 7.5	25	22	25	22	—	3.4	6 dp 3.5	M5 x 0.8	6	5
16		Thread: M4 x 0.7 Screw length 7.5	29	28	29	28	—	3.4	6 dp 3.5	M5 x 0.8	8	6
20		Thread: M6 x 1.0 Screw length 11.5	36	36	36	36	—	5.2	9 dp 5.5	M5 x 0.8	10	8
25		Thread: M6 x 1.0 Screw length 11.5	40	40	40	40	—	5.2	9 dp 5.5	M5 x 0.8	12	10

JQ1A series Compact Cylinder

Dimensions / JQ1A

CHELIC

JQ1A Ø32~Ø100

Mounting hole

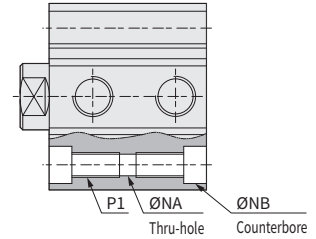
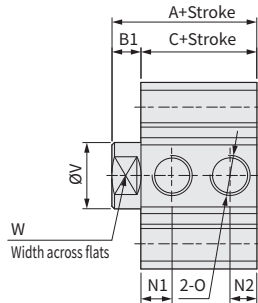
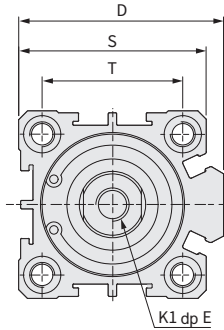

Unit: mm

Bore size	Stroke	Standard type				With magnet		B1	D	E	K1	N1		N2	
		A		C		A	C					Standard type	With magnet	Standard type	With magnet
		St ≤ 50	St ≥ 60	St ≤ 50	St ≥ 60										
32	Stroke = 5	30	40	23	33	40	33	7	49.5	13	M8 x 1.25	7.5	10.5	6.5	7.5
	Stroke > 5											10.5		7.5	
40		36.5	46.5	29.5	39.5	46.5	39.5	7	57	13	M8 x 1.25	11		8	
50	Stroke = 5	38.5	48.5	30.5	40.5	48.5	40.5	8	71	15	M10 x 1.5	9	10.5	9	10.5
	Stroke > 5											10.5		10.5	
63	Stroke = 5	44	54	36	46	54	46	8	84	15	M10 x 1.5	14	15	9.5	10.5
	Stroke > 5											15		10.5	
80		53.5	63.5	43.5	53.5	63.5	53.5	10	104	20	M16 x 2.0	16		14	
100		65	75	53	63	75	63	12	123.5	26	M20 x 2.5	20		17.5	

Bore size	Mark	O	P1	NA	NB	S	T	V	W
32	PT 1/8	Thread: M6 x 1.0 ; Screw length 11.5		5.2	9 dp 5.5	45	34	16	14
40	PT 1/8	Thread: M6 x 1.0 ; Screw length 11.5		5.2	9 dp 5.5	53	40	16	14
50	PT 1/4	Thread: M8 x 1.25 ; Screw length 15.5		6.8	10.5 dp 6.5	64	50	20	17
63	PT 1/4	Thread: M10 x 1.5 ; Screw length 19.5		8.5	14 dp 9	77	60	20	17
80	PT 3/8	Thread: M12 x 1.75 ; Screw length 24.5		10.4	17 dp 11	98	77	25	22
100	PT 3/8	Thread: M12 x 1.75 ; Screw length 24.5		10.4	17 dp 11	117	94	32	27

JQ1A series Compact Cylinder

Dimensions / JQ1A, JQ01A

CHELIC

JQ1A

JQ1A, JQ01A

Standard type

● Ø12~Ø25

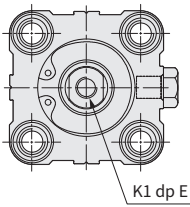

● Ø32~Ø63

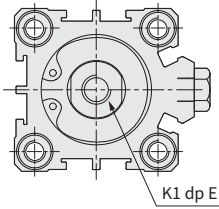

With magnet

● Ø12~Ø16

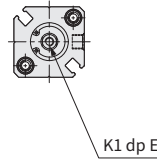

● Ø20~Ø25

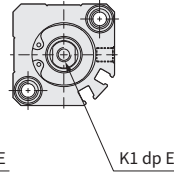

● Ø32~Ø63

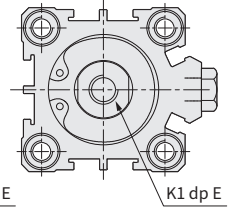

Mounting hole

JQ1A

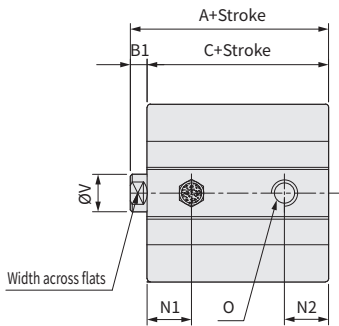

JQ01A

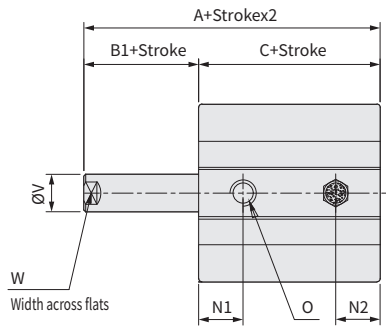

Unit: mm

Type	With magnet						Standard type						B1	E
Mark	A			C			A			C				
Bore size \ Stroke	5/10	15/20	25/30	5/10	15/20	25/30	5/10	15/20	25/30	5/10	15/20	25/30		
12	36.5	41.5	—	33	38	—	25.5	30.5	—	22	27	—	3.5	6
16	39	44	—	35.5	40.5	—	27	32	—	23.5	28.5	—	3.5	8
20	41	46	51	36.5	41.5	46.5	29	34	39	24.5	29.5	34.5	4.5	7
25	42.5	47.5	52.5	37.5	42.5	47.5	32.5	37.5	42.5	27.5	32.5	37.5	5	12
32	45	50	55	38	43	48	35	40	45	28	33	38	7	13
40	51.5	56.5	61.5	44.5	49.5	54.5	41.5	46.5	51.5	34.5	39.5	44.5	7	13
50	58.5	63.5	68.5	50.5	55.5	60.5	48.5	53.5	58.5	40.5	45.5	50.5	8	15
63	64	69	74	56	61	66	54	59	64	46	51	56	8	15

Mark	K1	O	V	W	N1		N2	
					Standard type	With magnet	Standard type	With magnet
12	M3 x 0.5	M5 x 0.8	6	5	7.5	9	5	7
16	M4 x 0.7	M5 x 0.8	8	6	8	9.5	5.5	
20	M5 x 0.8	M5 x 0.8	10	8	9	9.5	5.5	
25	M6 x 1.0	M5 x 0.8	12	10	11		5.5	
32	M8 x 1.25	PT 1/8	16	14	10.5		7.5	
40	M8 x 1.25	PT 1/8	16	14	11		8	
50	M10 x 1.5	PT 1/4	20	17	10.5		10.5	
63	M10 x 1.5	PT 1/4	20	17	15		10.5	

Note: Sizes without marks are the same as JQ1A series.

JQ1A series Compact Cylinder

Dimensions/ JQ1A

CHELIC

JQ1A - Adjustable stroke

With magnet

● Ø12~Ø16

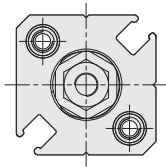

● Ø20~Ø25

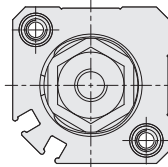

● Ø32~Ø100

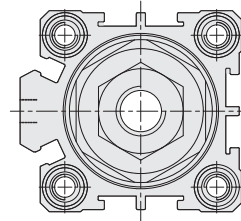

Standard type

● Ø12~Ø25

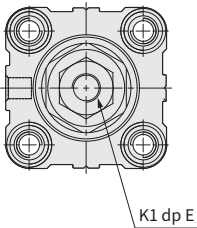

● Ø32~Ø100

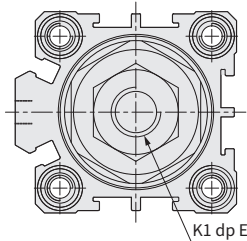

Adjustable stroke

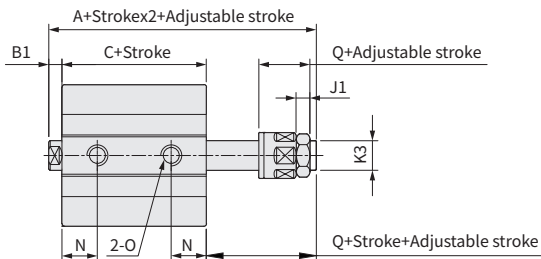

Unit: mm

Mark	Standard type		With magnet		B1	E	N	Q	J1	K3
	Bore size	Stroke	A	C						
12	45.2	25.2	52.4	32.4	3.5	6	9	17	4	M5x0.8
16	50	26	60	36	3.5	8	9.5	21	5	M6x1.0
20	55	26	67	38	4.5	7	9.5	25	6	M8x1.25
25	60.5	29	70.5	39	5	9.5 (S=5) 12 (S>5)	11	27	6	M10x1.25
32	64.9	30.5	74.9	40.5	7	9 (S≤10) 13 (S>10)	10	28	7	M12x1.25
40	74.5	40	84.5	50	7	11 (S≤10) 13 (S>10)	13	28	7	M12x1.25
50	77	40.5	87	50.5	8	12 (S≤10) 15 (S>10)	13.5	29	8	M16x1.5
63	78.4	42	88.4	52	8	12 (S≤10) 15 (S>10)	14.5 (S=5) 16 (S>5)	29	8	M16x1.5
80	95.8	51	105.8	61	10	14 (S≤15) 20 (S>15)	16	35.5	10	M20x1.5
100	114.3	60.5	124.3	70.5	12	20 (S≤25) 26 (Other)	21	42.5	13.5	M27x2.0

Note: sizes without marks are the same as JQ1A series.

JQ1A series Compact Cylinder

Dimensions / JQD1A

CHELIC

JQ1A

JQD1A

With magnet

● Ø12~Ø16

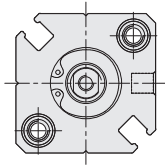

● Ø20~Ø25

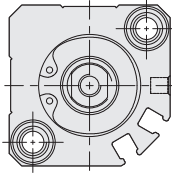

● Ø32~Ø100

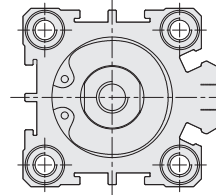

Standard type

● Ø12~Ø25

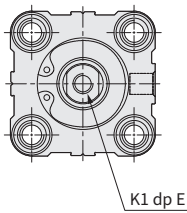

● Ø32~Ø100

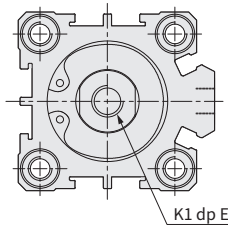

Mounting hole

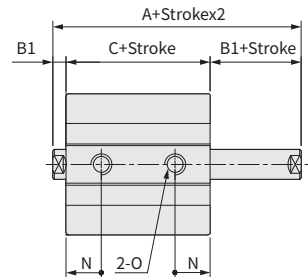

Unit: mm

Mark	Standard type		With magnet		B1	E	N
	Bore size	Stroke	A	C			
12	32.2	25.2	39.4	32.4	3.5	6	9
16	33	26	43	36	3.5	8	9.5
20	35	26	47	38	4.5	7	9.5
25	39	29	49	39	5	9.5 (S=5) 12 (S>5)	11
32	44.5	30.5	54.5	40.5	7	9 (S≤10) 13 (S>10)	10
40	54	40	64	50	7	11 (S≤10) 13 (S>10)	13
50	56.5	40.5	66.5	50.5	8	12 (S≤10) 15 (S>10)	13.5
63	58	42	68	52	8	12 (S≤10) 15 (S>10)	14.5 (S=5) 16 (S>5)
80	71	51	81	61	10	14 (S≤15) 20 (S>15)	16
100	84.5	60.5	94.5	70.5	12	20 (S≤25) 26 (Other)	21

Note: Sizes without marks are the same as JQ1A series. Please refer to below for the male thread size.

Male thread dimensions

Bore size Ø12~Ø100, Stroke ≤ 100

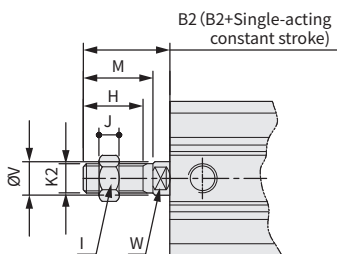

Unit: mm

Bore size	Mark	B2	H	I	J	K2	M	V	W
12		14	9	8	4	M5x0.8	10	6	5
16		15.5	10	10	5	M6x1.0	12	8	6
20		18.5	12	12	6	M8x1.25	14	10	8
25		22.5	15	17	6	M10x1.25	17.5	12	10
32		28.5	20.5	19	8	M14x1.5	23.5	16	14
40		28.5	20.5	19	8	M14x1.5	23.5	16	14
50		33.5	26	27	11	M18x1.5	28.5	20	17
63		33.5	26	27	11	M18x1.5	28.5	20	17
80		43.5	32.5	32	13	M22x1.5	35.5	25	22
100		43.5	32.5	36	13	M26x1.5	35.5	32	27

JQ1A series Compact Cylinder (Long stroke type)

Product features/ Code of order

CHELIC

Feature

- To execute JIS standard.(Long stroke type)
- Cylinder body, back cover, piston, and piston rod adopt riveted structure, Compact and reliable.
- Cylinder body is with better wear-resistance and durability by treated rolling process and hard anodizing process.
- The front cover has longer guiding distance and good guiding performance.
- Easy for sensor installation with notches.
- Various accessories are available.

Specification

Item	Bore size (mm)	Ø32	Ø40	Ø50	Ø63	Ø80	Ø100
Action		Double acting					
Fluid		Air (Filtered through a 40µm filter)					
Pressure range	MPa(psi)	0.15 ~ 1.0 (22 ~ 145)					
Withstand pressure	MPa(psi)	1.5 (215)					
Ambient and fluid temperature	°C	-20 ~ 70					
Piston speed	mm / s	30 ~ 150					
Stroke tolerance		+1.5 ~ 0					
Shock absorber		Cushion					
Port size		PT1/8		PT 1/4		PT 3/8	

Note: PT, NPT and G thread are available.

Stroke

Bore size (mm)	Standard stroke (mm)	Max. stroke	Accept stroke
Ø32, Ø40, Ø50, Ø63, Ø80, Ø100	125, 150, 175, 200, 250, 300	300	350

Note: 1. Within allowable strokes, please execute non-standard process when stroke > Max. stroke. Please contact us when execute other special strokes.

Code of order **JQ1A 20 x 30 - B - - - S 9T 2**



1	Mark	Model
	JQ1A	Double acting
	JQD1A	Double acting & Double-rod
	JQJ1A	Adjustable & Double-rod

2	Mark	Bore size (mm)
	32	Ø32
	40	Ø40
	50	Ø50
	63	Ø63
	80	Ø80
	100	Ø100

3	Bore size(mm)	Stroke (mm)
	Ø32, Ø40, Ø50, Ø63, Ø80, Ø100	125 ~ 300

● Refer to stroke list

4	Mark	Thread of shaft
	None	Female thread
	B	Male thread

5	Mark	Adjustable stroke (mm)
	10	10
	20	20
	30	30
	40	40
	50	50

● Only JQJ1A series has this option

6	Mark	Mounting type
	None	Without mounting accessory
	FA	Front flange
	FB	Rear flange
	CB	Double clevis
	LB	Foot mounting

● Dual-axis double-acting type without CB mounting type.

7	Mark	Magnet
	None	Without magnet
	S	With magnet

8	Mark	Sensor switch
	None	Without sensor switch
	9T	CS-9T

● Image

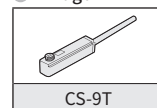

9	Mark	Sensor quantity
	None	Without sensor switch
	1	With 1 sensor switch
	2	With 2 sensor switches

JQ1A series Compact Cylinder (Long stroke type)

Dimensions / JQJ1A, JQD1A

CHELIC

Long stroke type

JQJ1A - Ø32~Ø100(Stroke>100)

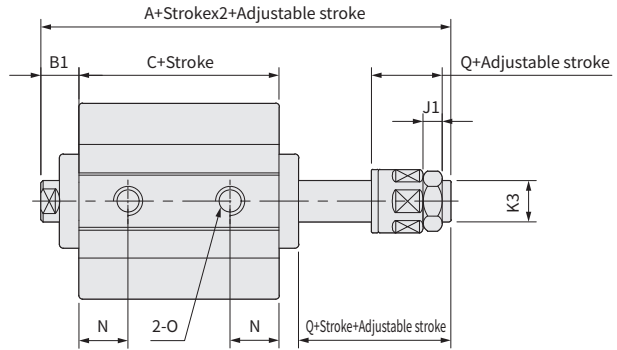
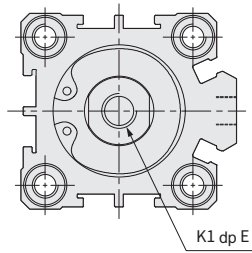

JQD1A - Ø32~Ø100(Stroke>100)

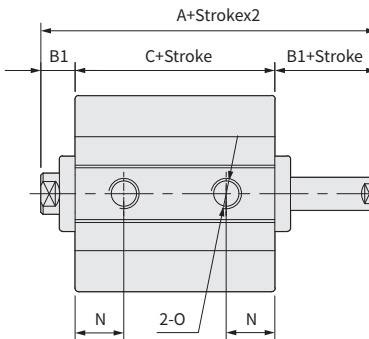
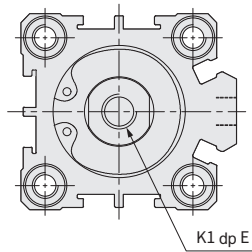

Unit: mm

Mark	Standard type			With magnet			B1	E	N	Q	J1	K3
	A		C	A		C						
	JQD1A	JQJ1A		JQD1A	JQJ1A							
32	79.5	95.5	45.5	89.5	105.5	55.5	17	13	12.5	28	7	M12 x 1.25
40	89	105	55	99	115	65	17	13	14	28	7	M12 x 1.25
50	91.5	107.5	55.5	101.5	117.5	65.5	18	15	14	29	8	M16 x 1.5
63	93	109	57	103	119	67	18	15	16.5	29	8	M16 x 1.5
80	106	126.5	66	116	136.5	76	20	21	19	35.5	10	M20 x 1.5
100	119.5	145	75.5	129.5	155	85.5	22	27	23	42.5	13.5	M27 x 2.0

Note: Sizes without marks are the same as JQ1A series. Please refer to P.6-3.10 for the male thread size.

JQ1A

JQ1A series Compact Cylinder (Long stroke type)

Dimensions / JQ1A, Male thread dimensions

CHELIC

Long stroke type

► JQ1A- Ø32~Ø100(Stroke >100)

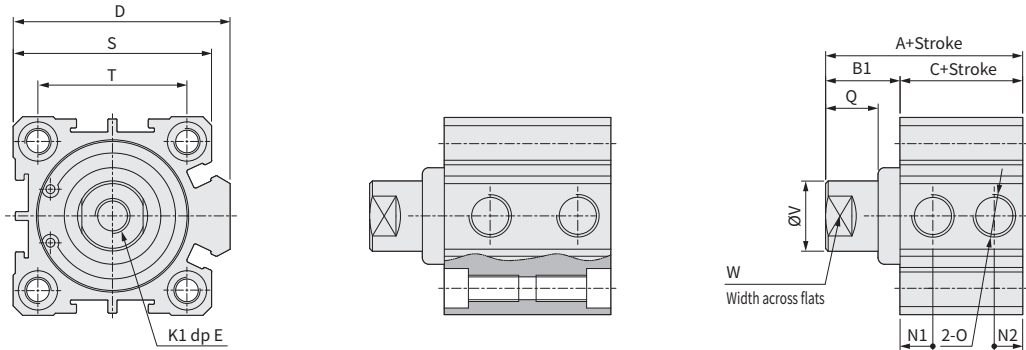

Unit: mm

Bore size	Mark	A	B1	C	D	E	K1	N	O	Q	S	T	V	W
32		62.5	17	45.5	49.5	13	M8x1.25	12.5	PT1/8	12	45	34	16	14
40		72	17	55	57	13	M8x1.25	14	PT1/8	12	53	40	16	14
50		73.5	18	55.5	71	15	M10x1.5	14	PT 1/4	13	64	50	20	17
63		75	18	57	84	15	M10x1.5	16.5	PT 1/4	13	77	60	20	17
80		86	20	66	104	21	M16x2.0	19	PT 3/8	15	98	77	25	22
100		97.5	22	75.5	123.5	27	M20x2.5	23	PT 3/8	17	117	94	32	27

Note: Sizes without marks are the same as JQ1A series.

Long stroke type - Male thread dimensions

► Bore size Ø32~Ø100, Stroke ≤ 100

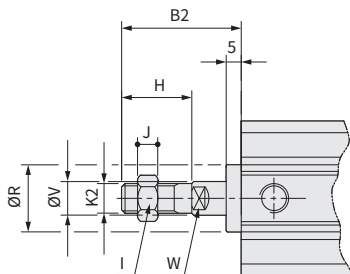

Unit: mm

Bore size	Mark	B2	H	I	J	K2	R	V	W
32		38.5	23.5	19	8	M14x1.5	22	16	14
40		38.5	23.5	19	8	M14x1.5	28	16	14
50		43.5	28.5	27	11	M18x1.5	35	20	17
63		43.5	28.5	27	11	M18x1.5	35	20	17
80		53.5	35.5	32	13	M22x1.5	43	25	22
100		53.5	35.5	36	13	M26x1.5	59	32	27

JQ1A series Compact Cylinder (Accessory)

Dimensions / Accessory

CHELIC

Code of order **JQ1A 20 - LB**



JQ1A

1	Mark	Model
	JQ1A	Double acting
	JQO1A	Single acting & Normal out
	JQI1A	Single acting & Normal in
	JQD1A	Double acting & Double-rod
	JQJ1A	Adjustable & Double-rod

2	Mark	Bore size (mm)
	12	Ø12
	16	Ø16
	20	Ø20
	25	Ø25
	32	Ø32
	40	Ø40
	50	Ø50
	63	Ø63
	80	Ø80
	100	Ø100

3	Mark	Mounting type
	None	Without mounting accessory
	FA	Front flange
	FB	End flange
	CB	Double clevis
	LB	Axial foot

● Dual-axis double-acting type without CB mounting type.

Accessory option

Model		Accessory	Mounting type				Joint type		Sensor switch
			LB	FA	FB	CB	I	Y	CS-9T
JQ1A	Female thread	Standard type	●	●	●	●		X	X
		With magnet	●	●	●	●		X	●
	Male thread	Standard type	●	●	●	●	●		X
		With magnet	●	●	●	●	●		●
JQI1A JQO1A JTQ1A	Female thread	Standard type	●	●	●	●		X	X
		With magnet	●	●	●	●		X	●
	Male thread	Standard type	●	●	●	●	●		X
		With magnet	●	●	●	●	●		●
JQD1A	Female thread	Standard type	●	●	X	X	X		X
		With magnet	●	●	X	X	X		●
	Male thread	Standard type	●	●	X	X	●		X
		With magnet	●	●	X	X	●		●
JQJ1A	Female thread	Standard type	●	●	X	X	X		X
		With magnet	●	●	X	X	X		●
	Male thread	Standard type	●	●	X	X	●		X
		With magnet	●	●	X	X	●		●

Accessory material list

Model	Accessory	Mounting type				Joint type	
		LB	FA	FB	CB	Y	I
12 ~ 16	Aluminum alloy			Aluminum alloy	SPCC	S45C	S45C
20 ~ 25				Aluminum alloy			
32 ~ 100				Cast copper	Cast copper		

JQ1A series Compact Cylinder (Accessory)

Dimensions/ Accessory - FA, FB Flange mounting

CHELIC

- Flange mounting - **FA** Front flange
- FB** Rear flange

▶ Ø12 ~ Ø25

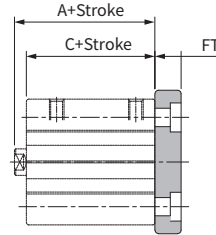
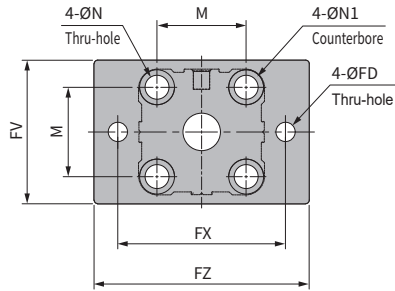

▶ Ø32 ~ Ø100

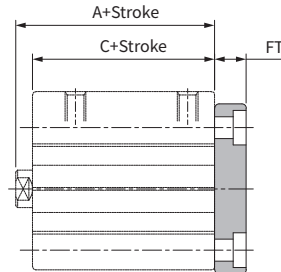
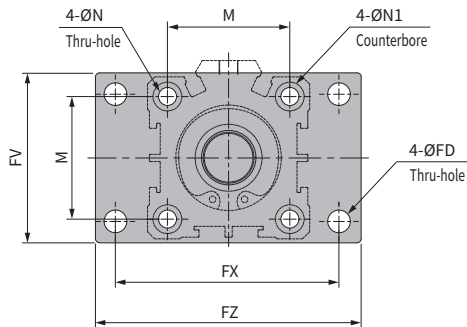

Unit: mm

Mark	Standard type				With magnet		M	N	N1	FD	FT	FV	FX	FZ
	Stroke		C		A	C								
	≤ 50	≥ 60	≤ 50	≥ 60										
12	20.5	—	17	—	31.5	28	15.5	4.5	7.5	4.5	5.5	25	45	55
16	22	—	18.5	—	34	30.5	20	4.5	7.5	4.5	5.5	30	45	55
20	24	34	19.5	29.5	36	31.5	25.5	6.5	10.5	6.5	8	39.5	48	60
25	27.5	37.5	22.5	32.5	37.5	32.5	28	6.5	10.5	6.5	8	42	52	64
32	30	40	23	33	40	33	34	6.5	10.5	5.5	8	48	56	65
40	36.5	46.5	29.5	39.5	46.5	39.5	40	6.5	10.5	5.5	8	54	62	72
50	38.5	48.5	30.5	40.5	48.5	40.5	50	8.5	13.5	6.5	9	67	76	89
63	44	54	36	46	54	46	60	10.5	16.5	9	10	80	92	108
80	53.5	63.5	43.5	53.5	63.5	53.5	77	12.5	18.5	11	12	99	116	134
100	65	75	53	63	75	63	94	12.5	18.5	11	12	117	136	154

JQ1A series Compact Cylinder (Accessory)

Dimensions/ Accessory - LB Foot mounting

CHELIC

JQ1A

Foot mounting - LB

▶ Ø12 ~ Ø25

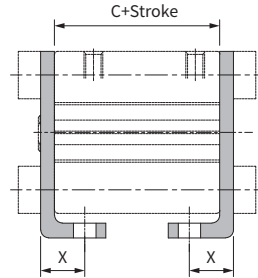
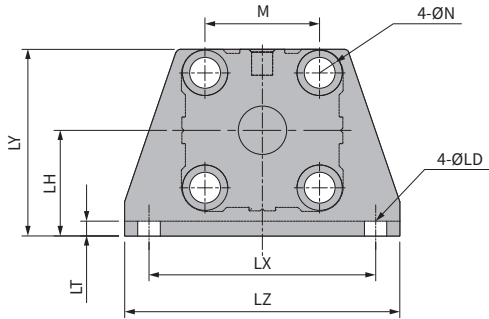

▶ Ø32 ~ Ø100

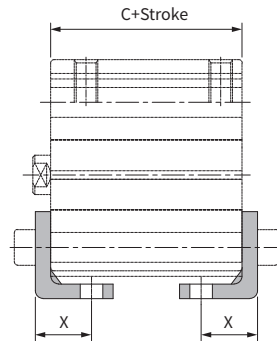
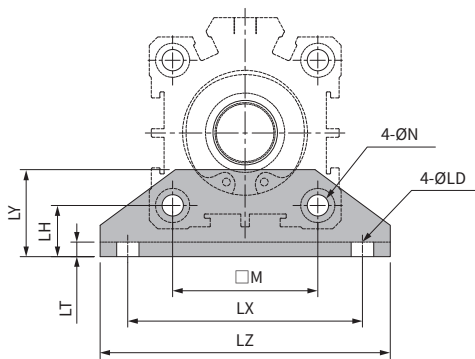

Unit: mm

Mark	C			M	N	X	LD	LH	LT	LX	LY	LZ
	Stroke	Standard type	With magnet									
Bore size	≤ 50	≥ 60										
12	17	—	28	15.5	4.5	8	4.5	17	2	34	29.5	44
16	18.5	—	30.5	20	4.5	8	4.5	19	2	38	33.5	48
20	19.5	29.5	31.5	25.5	6.5	9.2	6.5	24	3	48	42	62
25	22.5	32.5	32.5	28	6.5	10.7	6.5	26	3	52	46	66
32	23	33	33	34	6.5	11.2	6.5	13	3	57	20	71
40	29.5	39.5	39.5	40	6.5	11.2	6.5	13	3	64	20	78
50	30.5	40.5	40.5	50	8.5	12.2	8.5	14	3	79	22	95
63	36	46	46	60	10.5	13.7	10.5	16	3	95	26	113
80	43.5	53.5	53.5	77	13	16.5	13	20.5	4.5	118	32	140
100	53	63	63	94	13	23	13	24	6	137	36	162

JQ1A series Compact Cylinder (Accessory)

Dimensions/ Accessory - Double clevis

CHELIC

Pivot bracket - **CB** Double clevis

▶ Ø12 ~ Ø25

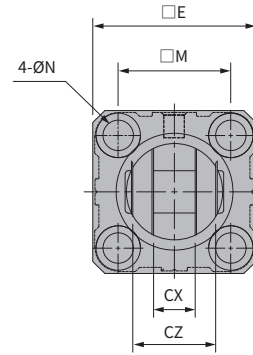
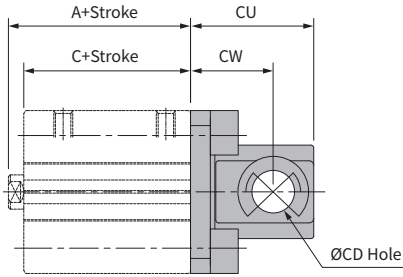

▶ Ø32 ~ Ø100

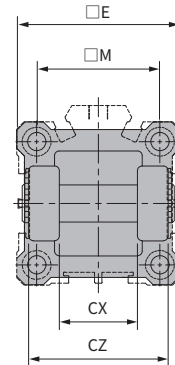
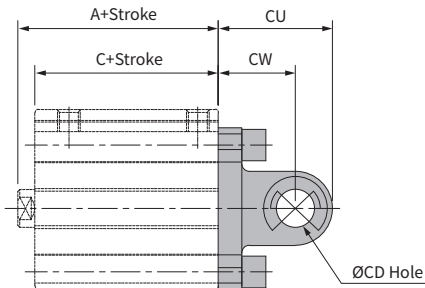

Unit: mm

Mark	Standard type				With magnet		E	M	N	CD	CU	CW	CX	CZ
	A		C		A	C								
	≤ 50	≥ 60	≤ 50	≥ 60										
12	20.5	—	17	—	31.5	28	25	15.5	4.5	5	20	14	5.3	9.8
16	22	—	18.5	—	34	30.5	29	20	4.5	5	21	15	6.8	11.8
20	24	34	19.5	29.5	36	31.5	36	25.5	6.5	8	27	18	8.3	15.8
25	27.5	37.5	22.5	32.5	37.5	32.5	40	28	6.5	10	30	20	10.3	19.8
32	30	40	23	33	40	33	45.5	34	6.5	10	30	20	18.3	35.8
40	36.5	46.5	29.5	39.5	46.5	39.5	53.5	40	6.5	10	32	22	18.3	35.8
50	38.5	48.5	30.5	40.5	48.5	40.5	64.5	50	8.5	14	42	28	22.3	43.8
63	44	54	36	46	54	46	77.5	60	10.5	14	44	30	22.3	43.8
80	53.5	63.5	43.5	53.5	63.5	53.5	98.5	77	12.5	18	56	38	28.3	55.8
100	65	75	53	63	75	63	117.5	94	12.5	22	67	45	32.3	63.8

Note: The A, C numbers above belongs to JQ1A series. For A, C numbers in other series, please refer to corresponding data.



Safety Notice/ JQ1A/ Caution For Application

CHELIC

JQ1A

- Please read this safety notice carefully, pay attention to safety item while using this product, in order to prevent injury to human body and damage of property.
- Pay attention to the individual caution for various model series (read the cautions and safety notice in P. 2 ~ P.3 for common cautions and safety notice).

Caution for design, selection



CAUTION

- Select cylinder with sufficient output when loading different objects.
- Select high-temperature resistance or anti-corrosion cylinder when using under high-temperature or corrosion environment.
- Cylinders should be protected if used in high-temperature, dusty environment. Or the environment with water-dropping, oil dust and welding dust.
- Before piping, the pipe should be cleaned proper to avoid dust and object flow to inner of cylinder.
- A 40µm filter products shall be applied before cylinder.
- Please don't select large stroke because the piston at the front cover is short.
- Under freezing Anti-frozen safeguard should be implemented to avoid freezing water in system.
- To prolong cylinder's life cycle, please avoid loading on side.
- If the cylinder will not be used for a long while, dustproof caps must be inserted for the surface rustproof. Please especially mind that the front and end covers cannot be dismantled.

Theoretical output

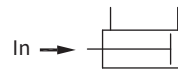
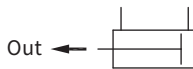

Unit: Newton(N)

Bore size (mm)	Rod diameter (mm)	Acting	Piston area (mm ²)	Air pressure (MPa)						
				0.1	0.2	0.3	0.4	0.5	0.6	0.7
Ø12	6	Push	113.1	—	13.6	24.9	36.2	47.5	58.9	70.2
		Pull	84.8	—	8.0	16.4	24.9	33.4	41.9	50.4
Ø16	8	Push	201.1	—	27.0	47.1	67.2	87.3	107.4	127.5
		Pull	150.8	—	17.0	32.0	47.1	62.2	77.3	92.4
Ø20	10	Push	314.2	—	36.8	68.2	99.7	131.1	162.5	193.9
		Pull	235.6	—	21.1	44.7	68.2	91.8	115.4	138.9
Ø25	12	Push	490.9	18.1	67.2	116.3	166.3	214.4	263.5	312.6
		Pull	377.8	6.8	44.6	82.3	120.1	157.9	195.7	233.4
Ø32	16	Push	804.2	27.4	107.8	188.3	268.7	349.1	429.5	510.0
		Pull	603.2	7.3	67.6	128.0	188.3	248.6	308.9	369.2
Ø40	16	Push	1256.6	44.7	170.3	296.0	421.7	547.3	673.0	798.6
		Pull	1055.6	24.6	130.1	235.7	341.2	446.8	552.3	657.9
Ø50	20	Push	1963.5	96.3	292.7	489.0	685.4	881.7	1078.1	1274.4
		Pull	1649.3	64.9	229.9	394.8	559.7	724.7	889.6	1054.5
Ø63	20	Push	3177.2	141.7	453.4	765.2	1076.9	1388.6	1700.3	2012.1
		Pull	2803.1	110.3	390.6	670.9	951.2	1231.5	1511.3	1792.2
Ø80	25	Push	5026.5	502.7	1005.3	1508.0	2010.6	2513.3	3015.9	3518.6
		Pull	4535.7	453.6	907.1	1360.7	1814.3	2267.8	2721.4	3175.0
Ø100	32	Push	7854.0	785.4	1570.8	2356.2	3141.6	3927.0	4712.4	5497.8
		Pull	7049.7	705.0	1409.9	2114.9	2819.9	3524.9	4229.8	4934.8

JQ1A series Compact Cylinder

Theoretical output

CHELIC

Theoretical output

● JQ11A

● JQ01A

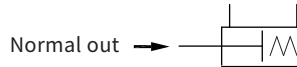
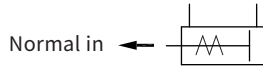

Unit: Newton(N)

Acting (mm)	Bore size (mm)	Rod diameter (mm)	Piston area (mm ²)	Air pressure (MPa)						
				0.1	0.2	0.3	0.4	0.5	0.6	0.7
Normal in	12	6	113.1	11.3	22.6	33.9	45.2	56.5	67.9	79.2
	16	6	201.1	20.1	40.2	60.3	80.4	100.5	120.6	140.7
	20	10	314.2	31.4	62.8	94.2	125.7	157.1	188.5	219.9
	25	12	490.9	49.1	98.2	147.3	196.3	245.4	294.5	343.6
	32	16	804.2	80.4	160.8	241.3	321.7	402.1	482.5	563.0
	40	16	1256.6	125.7	251.3	377.0	502.7	628.3	754.0	879.6
	50	20	1963.5	196.3	392.7	589.0	785.4	981.7	1178.1	1374.4
	63	20	3117.2	311.7	623.4	935.2	1264.9	1558.6	1870.3	2182.1
Normal out	12	6	84.8	8.5	17.0	25.4	33.9	42.4	50.9	59.4
	16	6	150.8	15.1	30.2	45.2	60.3	75.4	90.5	105.6
	20	10	235.6	23.6	47.1	70.7	94.2	117.8	141.4	164.9
	25	12	377.8	37.8	75.6	113.3	151.1	188.9	226.7	264.4
	32	16	603.2	60.3	120.6	181.0	241.3	301.6	361.9	422.2
	40	16	1055.6	105.6	211.1	316.7	422.2	527.8	633.3	738.9
	50	20	1649.3	164.9	329.9	494.8	659.7	824.7	989.6	1154.5
	63	20	2803.1	280.3	560.6	840.9	1121.2	1401.5	1681.9	1962.2