

JDM series Tandem Compact Cylinder

Product features

CHELIC

Internal structure

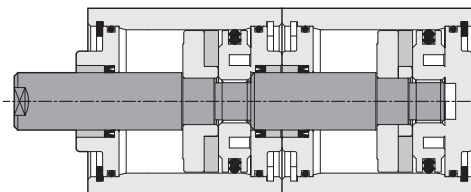

Specification

Item	Bore size	20	25	32	40	50	63	80	100
Action		Double acting							
Fluid		Air							
Pressure range	kgf/cm ² (kPa)	1.5 ~ 7 (150 ~ 700)			1 ~ 7 (100 ~ 700)				
Max. service pressure	kgf/cm ² (kPa)	9 (900)							
Port size		M5 x 0.8P		PT 1/8		PT 1/4		PT 3/8	
Ambient and fluid temperature	°C	-5 ~ +60							
Sensor switch		Option (S: With magnet)							

Standard stroke

JDM - <input type="checkbox"/> Compact Cylinder	Magnet device	Standard type (without magnet)								With magnet							
	Bore size	20	25	32	40	50	63	80	100	20	25	32	40	50	63	80	100
	Standard stroke range	10, 20, 30, 40, 50, 60, 75, 85, 100								10, 20, 30, 40, 50, 65, 75, 90							

※Note: 1. Non-standard stroke is special made, please contact with our sales.

Code of order

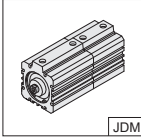
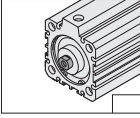
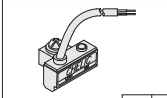
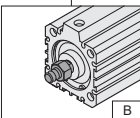
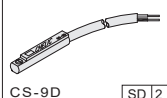
JDM	×	32	×	20	—	B	—	S	E	2
Model		Bore size		Stroke		Thread type		Sensor switch		
		20 - Ø20 mm 25 - Ø25 mm 32 - Ø32 mm 40 - Ø40 mm 50 - Ø50 mm 63 - Ø63 mm 80 - Ø80 mm 100 - Ø100 mm		10 ~ 100 mm <small>Please refer standard stroke table</small>		 None: Female thread			SE	2
JDM: Compact cylinder						 B : Male thread		None: Without sensor switch SE : Sensor switch code (CS-30E) 2 : Number of sensor switch 1 = 1 PCS 2 = 2 PCS		
									SD	2
								None: Without sensor switch SD : Sensor switch code (CS-9D) SB : Sensor switch code (CS-9B) 2 : Number of sensor switch 1 = 1 PCS		

Note :

- Standard type is female thread
- Male thread must be marked "B"

NA

NA2

NB

NU

ND

NQ

MSI

JQ

JD

JG

JTD

JTF

JCB

JCF

JE

JM

JDM series Tandem Compact Cylinder

Dimension

CHELIC

Male thread dimension

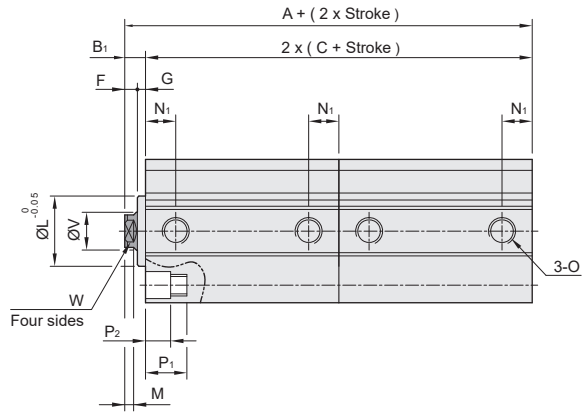
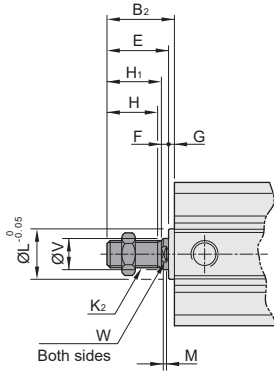

JDM Ø20 ~ Ø25

JDM Ø32 ~ Ø100

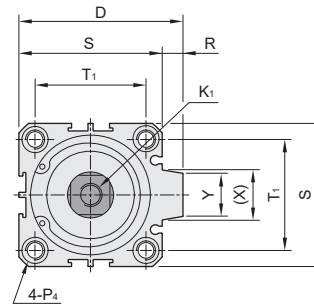
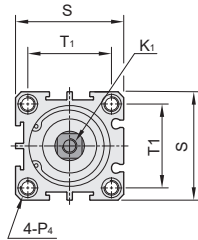

※ Note: Non-standard stroke is special made, please contact with our sales.

Mark Bore size (mm)	Standard type		With magnet		B ₁	B ₂	D	E	F	G	H	H ₁	K ₁	K ₂	L	M	N ₁
	A	C	A	C													
20	44.5	19.5	64.5	29.5	5.5	19.5	—	18	4	1.5	13	14	M4 x 0.7P x 10 dp	M6x1P	13	3	7.5
25	48.4	21.2	68.4	31.2	6	22	—	20.1	4.1	1.9	15	16	M5 x 0.8P x 12 dp	M8x1.25P	17	3	8
32	55	24	75	34	7	24	50	20.7	3.7	3.3	16	17	M6 x 1P x 14 dp	M10x1.25P	22	3	9
40	60	26.5	80	36.5	7	34	58	30.7	3.7	3.3	25	27	M8 x 1.25P x 14 dp	M14x1.5P	28	3	10
50	66.2	28.6	86.2	38.6	9	36	71	32.1	5.1	3.9	25	27	M10 x 1.5P x 15 dp	M18x1.5P	38	3	10.85
63	73.5	32.5	93.5	42.5	8.5	35.5	84.5	31.6	4.6	3.9	25	27	M10 x 1.5P x 15 dp	M18x1.5P	40	3	11
80	93.3	41.3	113.3	51.3	10.7	43.7	104	38.7	5.7	5	30	33	M14 x 1.5P x 20 dp	M22x1.5P	45	4	13
100	99.3	45.3	119.3	55.3	8.7	41.7	124	38.7	5.7	3	30	33	M16 x 2.0P x 20 dp	M22x1.5P	45	4	15

Mark Bore size (mm)	O	P ₄ (Mounting hole)	P ₁	P ₂	R	S	T ₁	V	W	X	Y
25	M5X0.8P	Thread M6x1Px8 dp; Hole Ø8x6 dp	14	6	—	40	28	10	8	—	—
32	PT 1/8	Thread M6x1Px8 dp; Hole Ø8x6 dp	14	6	6	44	34	12	10	15	13.6
40	PT 1/8	Thread M8x1.25Px10 dp; Hole Ø10x8 dp	18	8	6	52	40	16	14	15	13.6
50	PT 1/4	Thread M8x1.25Px10 dp; Hole Ø11x8.5 dp	18.5	8.5	9	62	48	20	17	21.6	19
63	PT 1/4	Thread M8x1.25Px10 dp; Hole Ø11x8.5 dp	18.5	8.5	9.5	75	60	20	17	23.5	20.5
80	PT 3/8	Thread M12x1.75Px12 dp; Hole Ø14x10.5 dp	22.5	10.5	10	94	74	25	22	27.6	25
100	PT 3/8	Thread M14x2Px15 dp; Hole Ø18.5x13 dp	28	13	10	114	90	25	22	27.6	25

JD(G) series Compact Cylinder

Bracket dimensions

CHELIC

Foot mounting type - LB

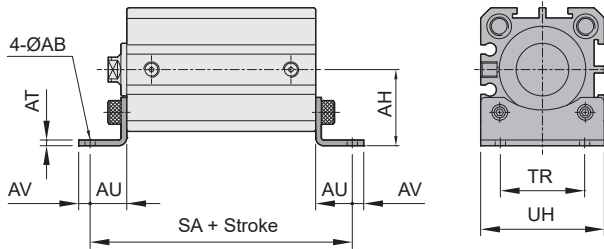

Mark	AB	AT	AV	AU	AH	TR	UH	SA
Ø06	3.5	2	4	6	12	23	30	37
Ø10	3.5	2	4	6	15	27	35	47
Ø12	4.5	2	4.5	8	17	34	44	36.5
Ø16	4.5	2	5	8	19	38	48	37.5
Ø20	6.6	3.2	5.8	9.2	24	44	60	37.9
Ø25	6.6	3.2	5.8	10.7	26	51	64	42.6
Ø32	6.6	3.2	5.8	11.2	30	56	68	46.4
Ø40	6.5	3.2	7	11.2	33	63	78	48.9
Ø50	9	3.2	8	14.7	39	77	96	58
Ø63	9	4.8	10	32	51.75	50	75	96.5

JD(G) series Compact Cylinder

Sensor switch operating range and the setting

CHELIC

☛ Sensor switch installation CS-30E

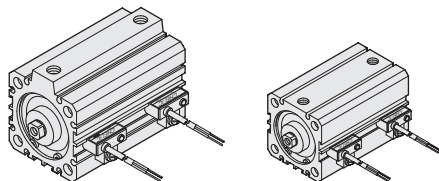

● Suitable for $\varnothing 12 \sim \varnothing 100$

☛ Sensor switch installation CS-9D

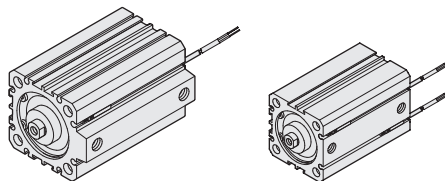

● Suitable for $\varnothing 6 \sim \varnothing 125$

☛ Sensor switch setting and operating range

● CS-30E

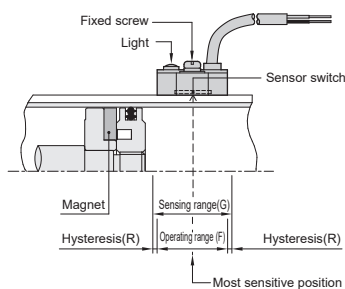

● CS-9D(B)

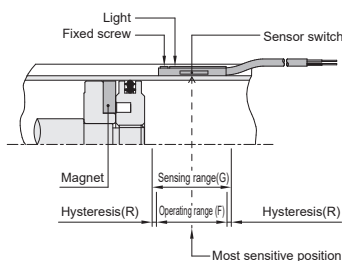

☛ Sensing range

Sensor switch is fixed on the cylinder body. The magnetic piston head will activate the sensor switch when it enters the operating range. It has 0.5mm differential.

☛ Operating range

When piston head moves the switch setting and adjustment will be based on the responding range generated by the magnetic field and the switch. (Please refer to the right table)

☛ Sensor switch introduction

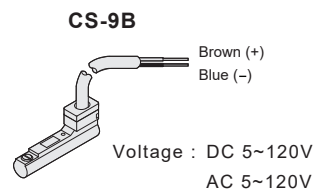
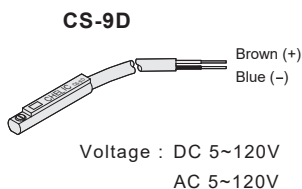
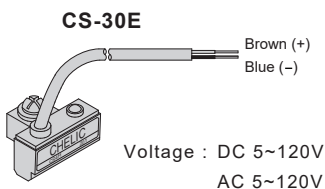

Unit: mm

Model	CS-30E		CS-9D(B)	
	Operating range(F)	Hysteresis(R)	Operating range(F)	Hysteresis(R)
$\varnothing 6$	—	—	5	1
$\varnothing 10$	—	—	8	1
$\varnothing 12$	9	1	8	1
$\varnothing 16$	11	1	10	1
$\varnothing 20$	9	1	8	1
$\varnothing 25$	11	1	9	1
$\varnothing 32$	8.5	1	7	1
$\varnothing 40$	11	1	8	1
$\varnothing 50$	11	1.2	9	1.2
$\varnothing 63$	13	1.2	10.5	1.2
$\varnothing 80$	14	1.3	13.5	1.4
$\varnothing 100$	15	1.3	13.5	1.5
$\varnothing 125$	—	—	12	2

NA

NA2

NB

NU

ND

NQ

MSI

JQ

JD

JG

JTD

JTF

JCB

JCF

JE

JM

JD(G) series Compact Cylinder

Dimension-Sensor switch

CHELIC

● Sensor switch position dimension

● $\varnothing 12, \varnothing 16$

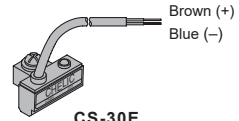
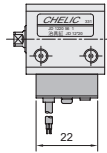
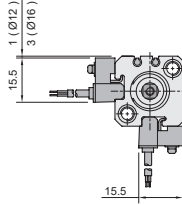

CS-30E

Voltage: DC 5 ~ 120 V
AC 5 ~ 120 V

● $\varnothing 20, \varnothing 63$

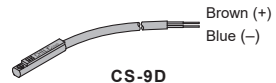
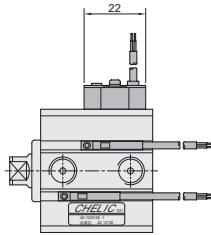
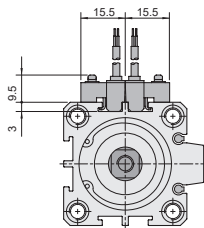

CS-9D

Voltage: DC 5 ~ 120 V
AC 5 ~ 120 V

● $\varnothing 80, \varnothing 100$

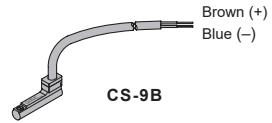
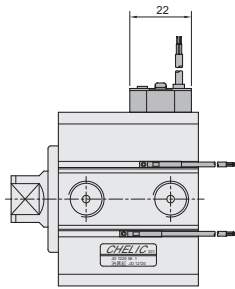
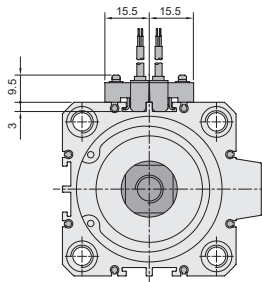

CS-9B

Voltage: DC 5 ~ 120 V
AC 5 ~ 120 V

● Sensor switch mounting

● $\varnothing 6, \varnothing 10$

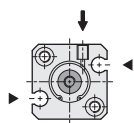

● $\varnothing 12, \varnothing 16$

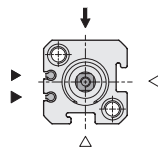

● $\varnothing 20, \varnothing 25$

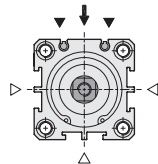

● $\varnothing 32, \varnothing 40$

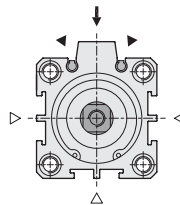

● $\varnothing 50, \varnothing 63$

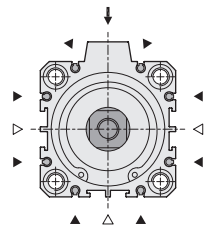

● $\varnothing 80, \varnothing 100$

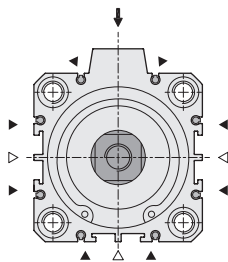

● $\varnothing 125$

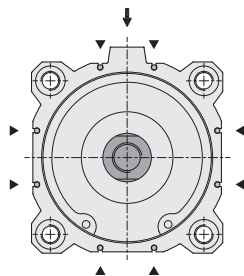

Legend :

- ▲ : Groove for installing CS-9D(B)
- △ : Groove for installing CS-30E
- ↓ : Direction of piping port

JD(G) series Compact Cylinder/ Mounting Screw

Dimension-Accessory

CHELIC

○ The body length and Screw specification (Reference)

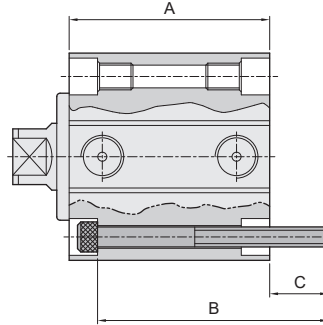
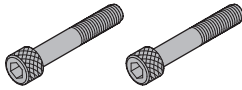

Model	A	B	C	Screw size
JD 6 X 5	30.0	35	7.5	M2.5 X 35L
JD 6 X 10	35.0	40	7.5	M2.5 X 40L
JD 6 X 15	40.0	45	7.5	M2.5 X 45L
JD 6 X 20	45.0	50	7.5	M2.5 X 50L
JD 6 X 25	50.0	55	7.5	M2.5 X 55L
JD 6 X 30	55.0	60	7.5	M2.5 X 60L
JD10 X 5	40.0	45	7.5	M2.5 X 45L
JD10 X 10	45.0	50	7.5	M2.5 X 50L
JD10 X 15	50.0	55	7.5	M2.5 X 55L
JD10 X 20	55.0	60	7.5	M2.5 X 60L
JD10 X 25	60.0	65	7.5	M2.5 X 65L
JD10 X 30	65.0	70	7.5	M2.5 X 70L
JD12 X 5	25.5	25	4	M3 X 25L
JD12 X 10	30.5	30	4	M3 X 30L
JD12 X 15	35.5	35	4	M3 X 35L
JD12 X 20	40.5	40	4	M3 X 40L
JD12 X 25	45.5	45	4	M3 X 45L
JD12 X 30	50.5	50	4	M3 X 50L
JD12 X 40 (35)	60.5	60	4	M3 X 60L
JD12 X 50 (45)	70.5	70	4	M3 X 70L
JD16 X 5	26.5	30	8	M3 X 30L
JD16 X 10	31.5	35	8	M3 X 35L
JD16 X 15	36.5	40	8	M3 X 40L
JD16 X 20	41.5	45	8	M3 X 45L
JD16 X 25	46.5	50	8	M3 X 50L
JD16 X 30	51.5	55	8	M3 X 55L
JD16 X 40 (35)	61.5	65	8	M3 X 65L
JD16 X 50 (45)	71.5	75	8	M3 X 75L
JD20 X 10 (5)	29.5	35	10.5	M4 X 35L
JD20 X 20 (15)	39.5	45	10.5	M4 X 45L
JD20 X 30 (25)	49.5	55	10.5	M4 X 55L
JD20 X 40 (35)	59.5	65	10.5	M4 X 65L
JD20 X 50 (45)	69.5	75	10.5	M4 X 75L
JD25 X 10 (5)	31.2	35	9.8	M4 X 35L
JD25 X 20 (15)	41.2	45	9.8	M4 X 45L
JD25 X 30 (25)	51.2	55	9.8	M4 X 55L
JD25 X 40 (35)	61.2	65	9.8	M4 X 65L
JD25 X 50 (45)	71.2	75	9.8	M4 X 75L
JD32 X 10 (5)	34.0	40	12	M4 X 40L
JD32 X 20 (15)	44.0	50	12	M4 X 50L
JD32 X 30 (25)	54.0	60	12	M4 X 60L
JD32 X 40 (35)	64.0	70	12	M4 X 70L
JD32 X 50 (45)	74.0	80	12	M4 X 80L

Note: 1. C value is for reference only. Design value shall be subject to the stress and strain of the locking material.
2. Mounting screw, please refer JIS B1176 Hexagon socket screw (Alloy steel).

Model	A	B	C	Screw size
JD40 X 10 (5)	36.5	40	11.5	M5 X 40L
JD40 X 20 (15)	46.5	50	11.5	M5 X 50L
JD40 X 30 (25)	56.5	60	11.5	M5 X 60L
JD40 X 40 (35)	66.5	70	11.5	M5 X 70L
JD40 X 50 (45)	76.5	80	11.5	M5 X 80L
JD40 X 60 (55)	86.5	90	11.5	M5 X 90L
JD40 X 75	101.5	110	16.5	M5 X 110L
JD50 X 10 (5)	38.6	40	9.9	M6 X 40L
JD50 X 20 (15)	48.6	50	9.9	M6 X 50L
JD50 X 30 (25)	58.6	60	9.9	M6 X 60L
JD50 X 40 (35)	68.6	70	9.9	M6 X 70L
JD50 X 50 (45)	78.6	80	9.9	M6 X 80L
JD50 X 60 (55)	88.6	90	9.9	M6 X 90L
JD50 X 75	103.6	110	14.9	M6 X 110L
JD63 X 10 (5)	42.5	50	16	M6 X 50L
JD63 X 20 (15)	52.5	60	16	M6 X 60L
JD63 X 30 (25)	62.5	70	16	M6 X 70L
JD63 X 40 (35)	72.5	80	16	M6 X 80L
JD63 X 50 (45)	82.5	90	16	M6 X 90L
JD63 X 60 (55)	92.5	100	16	M6 X 100L
JD63 X 75	107.5	120	21	M6 X 120L
JD80 X 10 (5)	51.3	60	19.2	M8 X 60L
JD80 X 20 (15)	61.3	70	19.2	M8 X 70L
JD80 X 30 (25)	71.3	80	19.2	M8 X 80L
JD80 X 40 (35)	81.3	90	19.2	M8 X 90L
JD80 X 50 (45)	91.3	100	19.2	M8 X 100L
JD80 X 60 (55)	101.3	110	19.2	M8 X 110L
JD80 X 75	116.3	130	24.2	M8 X 130L
JD100 X 10 (5)	55.3	65	22.7	M10 X 65L
JD100 X 20 (15)	65.3	75	22.7	M10 X 75L
JD100 X 30 (25)	75.3	85	22.7	M10 X 85L
JD100 X 40 (35)	85.3	95	22.7	M10 X 95L
JD100 X 50 (45)	95.3	110	27.7	M10 X 110L
JD100 X 60 (55)	105.3	120	27.7	M10 X 120L
JD100 X 75	120.3	130	22.7	M10 X 130L
JD125 X 10 (5)	93.0	100	20.0	M12 X 100L
JD125 X 20 (15)	103.0	110	20.0	M12 X 110L
JD125 X 30 (25)	113.0	120	20.0	M12 X 120L
JD125 X 40 (35)	123.0	130	20.0	M12 X 130L
JD125 X 50 (45)	133.0	140	20.0	M12 X 140L
JD125 X 75	158.0	170	25.0	M12 X 170L
JD125 X 100	183.0	190	20.0	M12 X 190L

NA

NA2

NB

NU

ND

NQ

MSI

JQ

JD

JG

JTD

JTF

JCB

JCF

JE

JM